

2-108

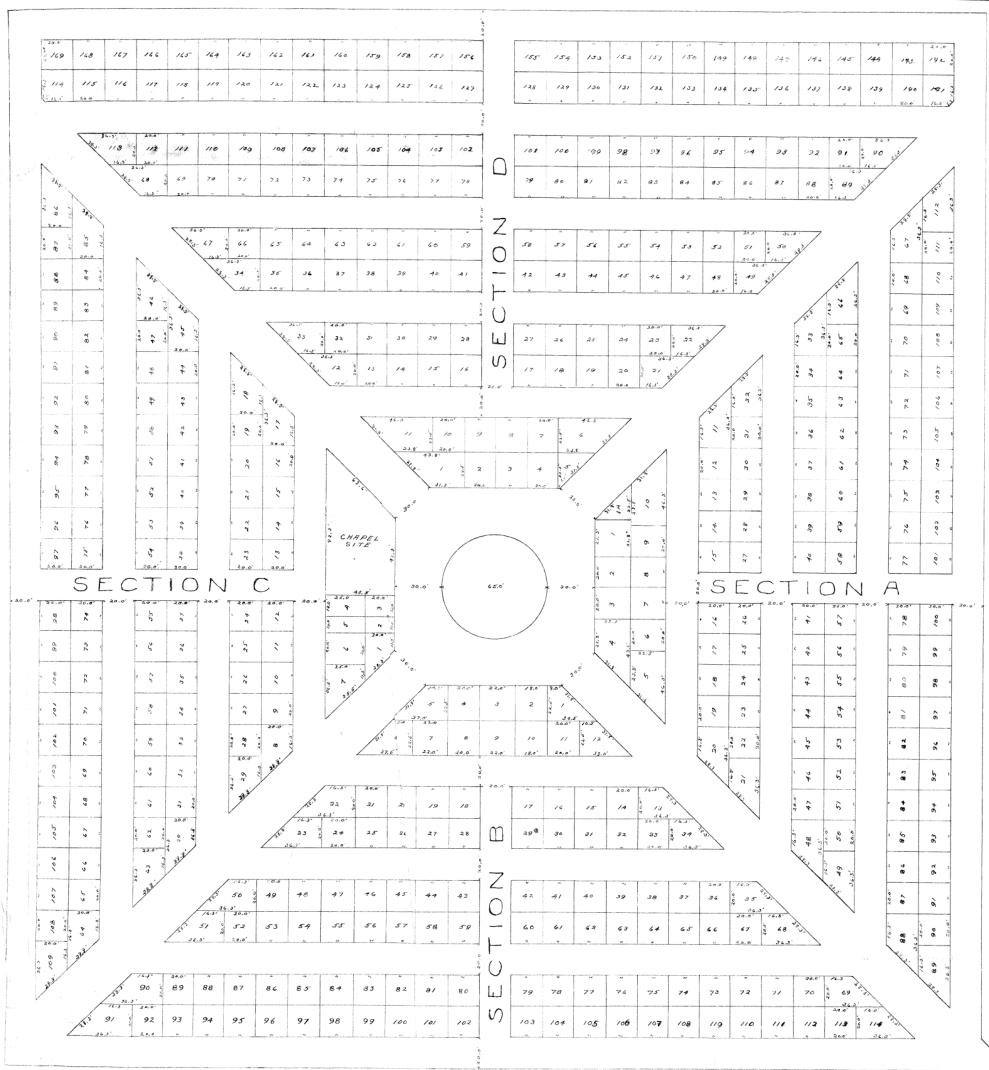

State of Florida,
Dade County,

Know all men by these presents: That
The South Dade Cemetery Association, a corporation
under the laws of Florida, has caused to be prepared
for record the attached map of THE PALMS CEM-
ETERY, the same being a subdivision of NE 1/4 of
SW 1/4 of NE 1/4 of Sec. 33, T. 36 S., R. 39 E.; that the
said map has been approved by the Board of Direc-
tors of said Association and by them ordered placed
on record.

In testimony whereof the said South
Dade Cemetery Association has caused the
signatures of its President and Secretary to be
herein attached this 15th day of October 1915.

Witness:
Miner H. Davis,
Johnnie Marsh

A. H. Neam
Secretary

State of Florida,
Dade County,

Filed for record this 23rd day of
Oct. 1915, and duly recorded Page
108 of Plat Book 2, Ch. 33 of Vol. 1
of Public Records.

J. H. Smith
Recorder

THE PALMS CEMETERY

A SUBDIVISION OF NE 1/4 of SW 1/4 of NE 1/4 of SEC. 33, T. 36 S., R. 39 E.

Scale: 1" = 20'

Pay & March